

Pronto Light Set Up Instructions

1. Set Pronto Banner Stand up by pulling graphic from retractable unit and placing the silver steel graphic attachment clip(C) into the mast. Your Pronto is now standing with the graphic displayed.

2. The Pronto light is fitted with a Light Base (A) Place the Light Base (A) over the top of the Pronto Mast (B).

3. Your Light Should rest with the bulb end over and in front of the graphic. the Electrical cord will fall behind the banner stand / graphic.

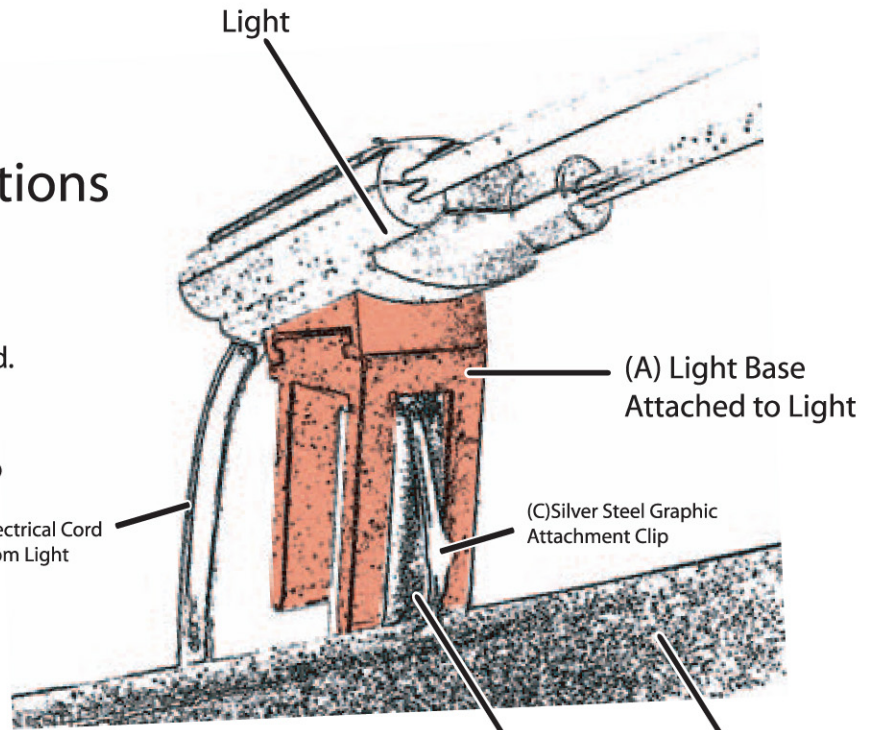

(B) Pronto Mast rises slightly above the Graphic when unit is set up.

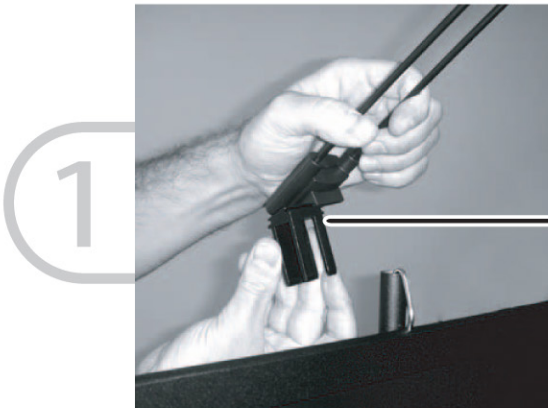

(A) Light Base Attached to Light

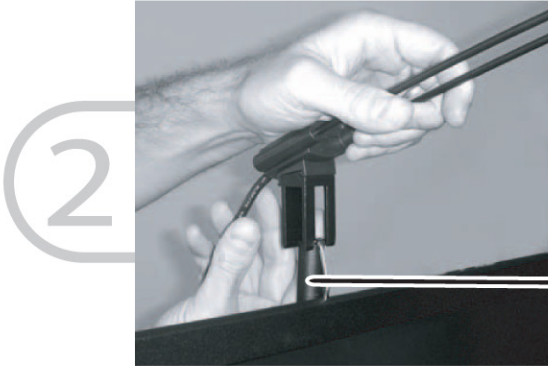

(B) Pronto Mast rises slightly above the Graphic when unit is set up.

