

# Set up Instruction

## Monitor Stand S10

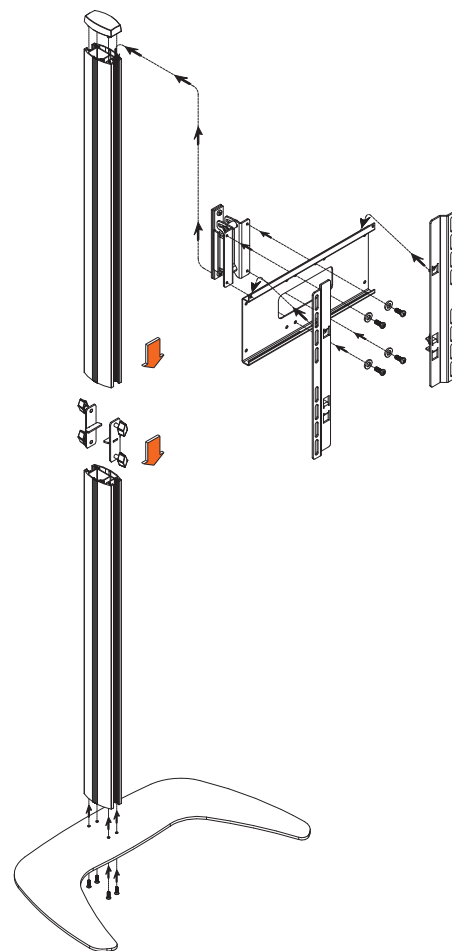
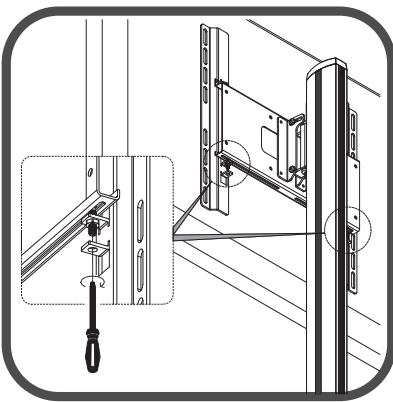
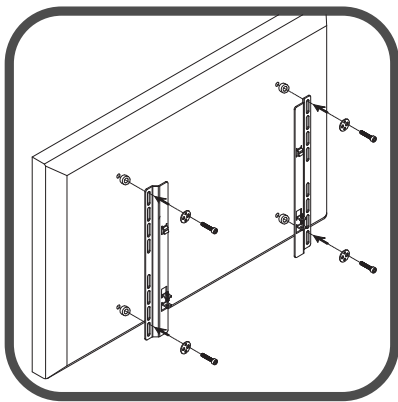
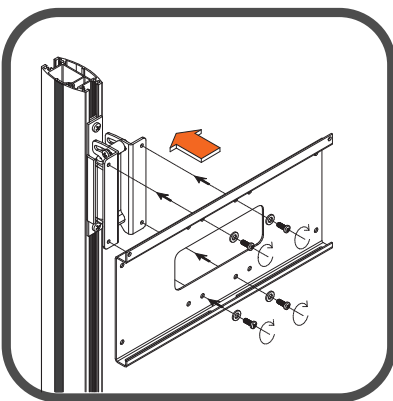
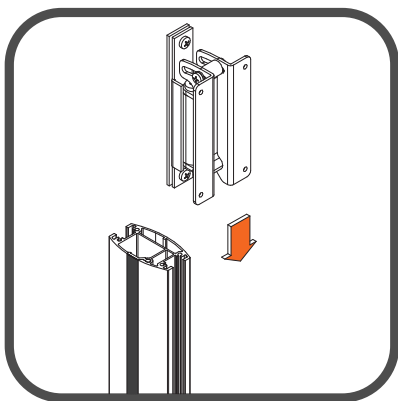
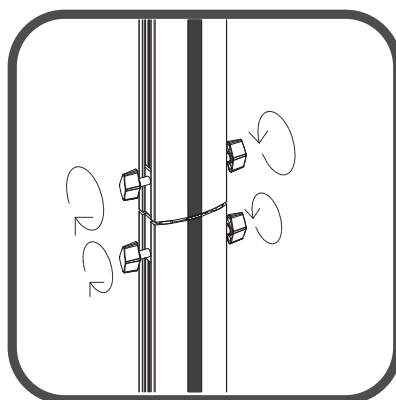
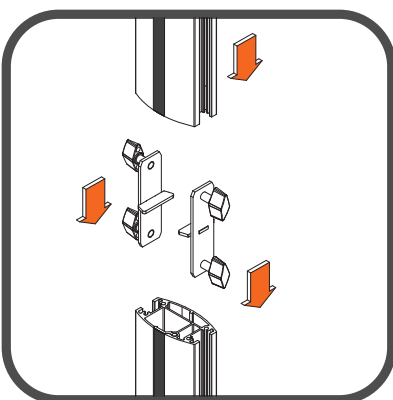
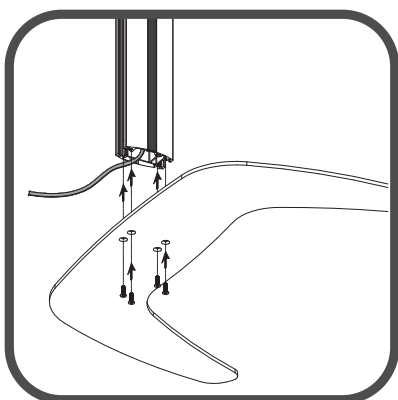

# Spennare Monitor Mount added to Pop Up Display

1. From the bottom corner closest to the area where the monitor mount will be positioned, pull the graphic up to insert the base & bottom section of the Spennare Monitor Mount into place. Then reattach graphic to the frame.

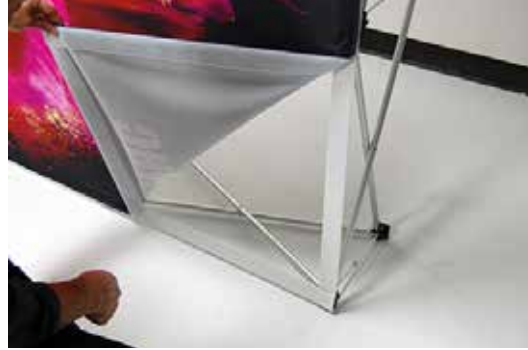

2. From the backside attach the top portion of the Spennare Monitor Mount and tighten.



3. Attach the monitor bracket to the Spennare Monitor Mount stand.

